



FITTING INSTRUCTIONS FOR

# Auto Levelling Headlight Bracket

SKU

**KS0857**

COMPATIBILITY

**Toyota Prado 150, LandCruiser LC200 & LC300**

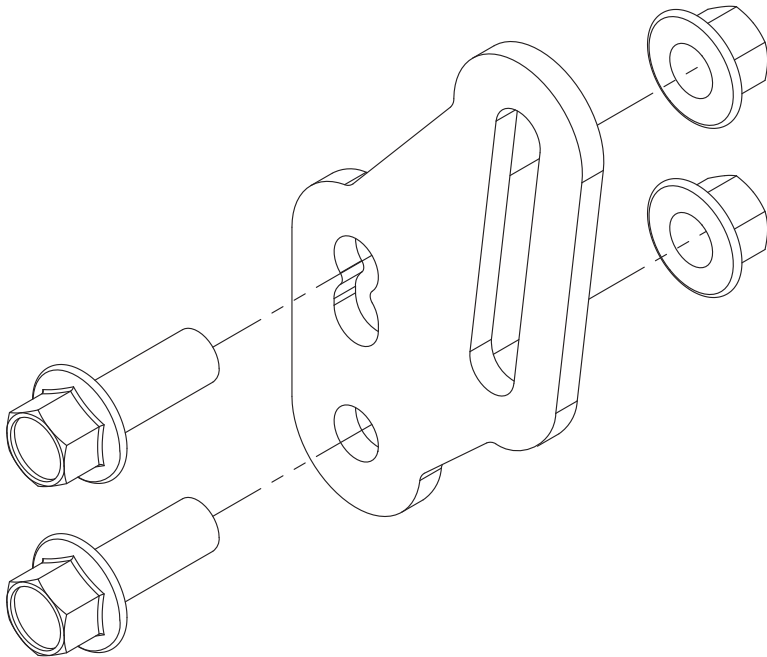

## Included contents

QTY	COMPONENT
1	Headlight Levelling Bracket
2	M6 x 16 Flanged Hex Bolt G8.8
2	M6 Flanged Nut



**Time**

10 minutes / Few sips of beer

For further information contact KAON on **07 3180 1470** or [info@kaon.com.au](mailto:info@kaon.com.au)



# The following instructions will vary, depending on your vehicle.

There are different installation steps for the Auto Levelling Headlight Bracket, depending on the kind of vehicle you are installing it to. Follow the steps as outlined below:

## Prado 150

### STEPS 1-6

Turn to page 3 for instructions on installing the Auto Levelling Headlight Bracket on the Prado 150.



## LandCruiser LC200

### STEPS 7-12

Turn to page 4 for instructions on installing the Auto Levelling Headlight Bracket on the LC200.



## LandCruiser LC300

### STEPS 13-18

Turn to page 5 for instructions on installing the Auto Levelling Headlight Bracket on the LC300.



## Bolt Torque

DIAMETER (mm)	5mm	6mm	8mm	10mm	12mm
NEWTON-METRES (Nm)	5 Nm	9 Nm	22 Nm	44 Nm	77 Nm

# Let's get to work.

## Prado 150 Installation

1. Locate the sensor arm mounting slot, and remove the nut connecting it to the factory mount.
2. Place the headlight levelling bracket behind the factory mount and thread through the two supplied M6 bolts. Ensure that they are secured through the bolt holes indicated in red.
3. Fasten the bracket to the factory mount using the M6 nuts.
4. Secure the sensor arm to the elongated slot in the headlight levelling bracket, using the factory nut.

**Please note:** the factory washer has a small tab to stop the thread spinning in place, ensure this tab sits on the outside of the headlight levelling bracket as pictured.

5. The sensor arm has a small indicator that lines up with a corresponding indicator on the sensor itself. Make sure these align and tighten all bolts to the recommended torque settings.
6. That's it, you're done!

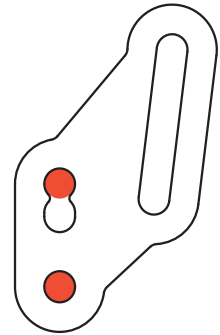
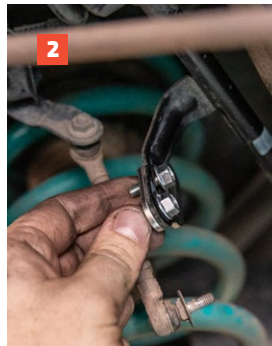
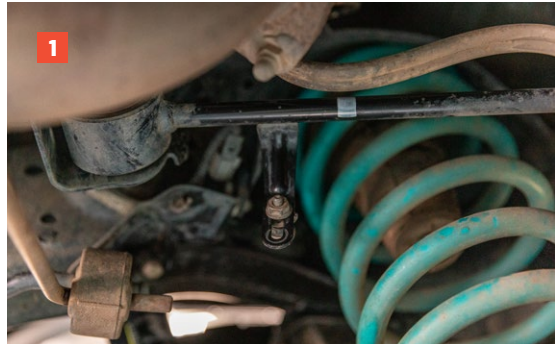

## LC200 Installation

7. Locate the sensor arm mounting slot, and remove the nut connecting it to the factory mount.
8. Position the headlight levelling bracket in front of the factory mount and thread through the two supplied M6 bolts. Ensure that they are secured through the bolt holes indicated in red.
9. Fasten the bracket to the factory mount using the M6 nuts.
10. Secure the sensor arm to the elongated slot in the headlight levelling bracket, using the factory nut.

**Please note:** the factory washer has a small tab to stop the thread spinning in place, ensure this tab sits on the outside of the headlight levelling bracket as pictured.

11. The sensor arm has a small indicator that lines up with a corresponding indicator on the sensor itself. Make sure these align and tighten all bolts to the recommended torque settings.
12. That's it, you're done!

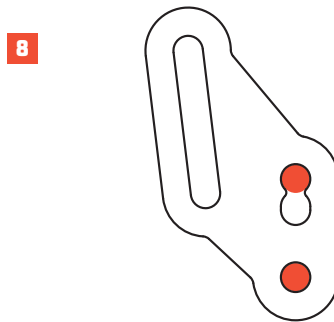

## LC300 Installation

13. Locate the sensor arm mounting slot, and remove the nut connecting it to the factory mount.
14. Position the headlight levelling bracket in front of the factory mount and thread through the two supplied M6 bolts. Ensure that they are secured through the bolt holes indicated in red.
15. Fasten the bracket to the factory mount using the M6 nuts.
16. Secure the sensor arm to the elongated slot in the headlight levelling bracket, using the factory nut.

**Please note:** the factory washer has a small tab to stop the thread spinning in place, ensure this tab sits on the outside of the headlight levelling bracket as pictured.

17. The sensor arm has a small indicator that lines up with a corresponding indicator on the sensor itself. Make sure these align and tighten all bolts to the recommended torque settings.
18. That's it, you're done!

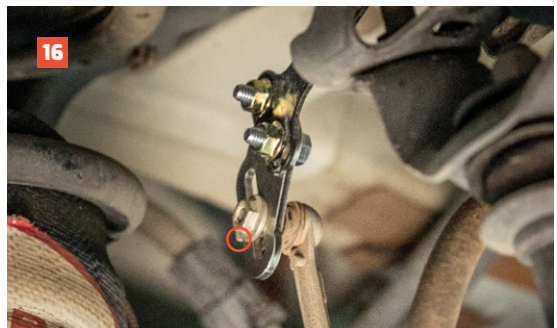
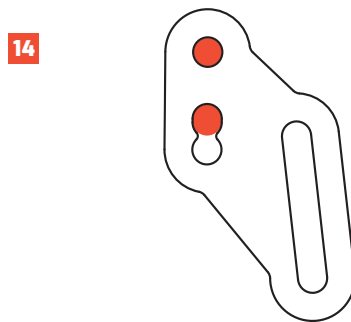
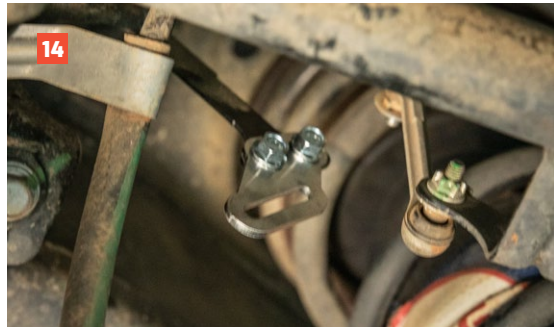





## **Local Knowledge & Assistance**

We know half the fun of building your dream 4x4 is getting your hands dirty. But we also know that sometimes, things don't go to plan. If in the pursuit to build the ultimate setup you find yourself off-track, we're here to help you get unstuck.

**For further information call 07 3180 1470 or email [info@kaon.com.au](mailto:info@kaon.com.au)**

Disclaimer: The products sold by KAON should not be modified, and are for use only on the vehicles specifically stated. KAON will not be liable for any damages arising out of the use or misuse of its products. It is the customers responsibility to ensure the products are safely and properly used and installed. KAON consistently seeks to improve its products and reserves the right to make changes to any product.