

ELECTRONICS

Email: info@tracelectronicis.com.au

Website: <https://tracelectronics.com.au/>

Model # T1HKIT

Tailgate central locking

Please refer to the owner's manual on the operation and functions of the central locking system.

Kit contents:

- Fully prewired harness approximately 3 meters in length with corresponding connectors to fit the factory connector and actuator
- Actuator
- Stainless Steel bracket
- Fabricated metal rod
- Cable ties
- Screws (x2 long)
- Torx bit -T30
- 3mm Hex shaft drill bit

Remove the cover off the tail gate, you will need the torx bit (T30) if you take off one of the end supports the trim can sometimes be slid off to one side otherwise you will need to dislodge the adhesive backing from the front and back underside of the tailgate liner.

NOTE: Some models may have an additional metal cover that will need to be removed to gain access to the rear of the latch.

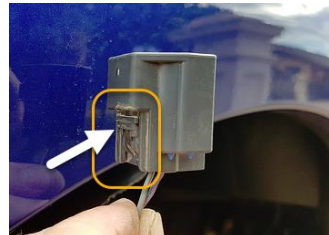

You do not need to take the complete inner guard off (rear passenger's side) you only need to remove a few of the front and top retaining clips to be able to get your hand up and release the connector.

To remove the retaining clips, use a Philips screwdriver to remove the central part first then the surrounding part if the assembly spins hold the outer part.

The connector on the actuator has a clip that needs to be depressed so it can be removed, the above image shows its approximate orientation and the clip to be depressed is on the left side of the image highlighted by the arrow.

NOTE: It's a two-pin connector directly on the actuator body that will need to be removed, not the two-pin connector lower down the wheel arch.

Then it's just a case of connecting in the new harness to the corresponding connectors.



Run the harness down on the right-hand side of the fuel inlet hose so it exits on the other side.



Then follow the existing cables back to the rear of the car, using the supplied cable ties to hold it in place.

Crossover to the outer side just passed the rear shackle pass through an existing opening out to the bottom of the tailgate.



Select where you want to have it enter into the tail gate, I used the very first opening, then into the main area of the tail gate.



NOTE: If you have the factory camera fitted, you can use the existing entry point through the grommet, you will need to remove a section of the split tubing before passing the cable through, and then refit the spit tubing once inside the tailgate.

Installation of the actuator & stainless steel bracket:

Before fitting the actuator to the stainless steel bracket, scribe a mark on the plastic latch assembly using the end of the stainless steel bracket as shown in the images below - this will assist with marking the point at which a centre hole will later be drilled into the plastic attachment.

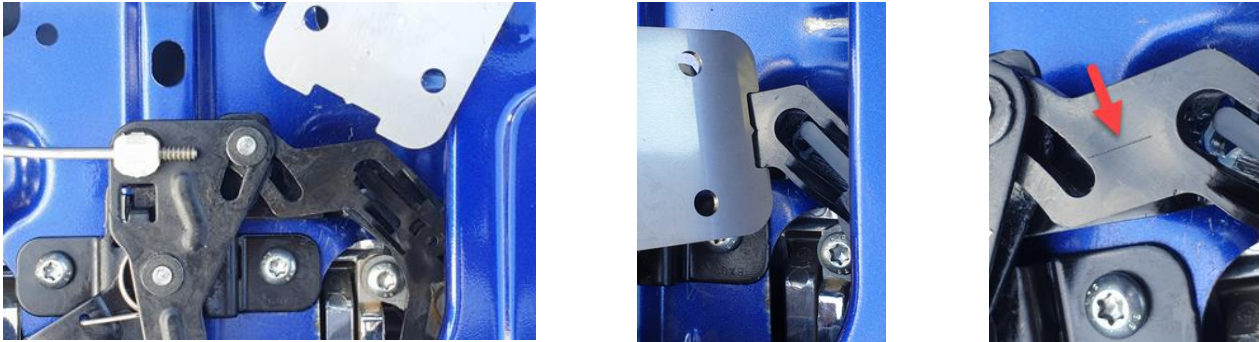

Remove the green head on the actuator **BEFORE** fitting to the bracket, by holding the actuator body in one hand and the green head in the other hand unclip by applying pressure to the head in the opposite direction of the opening (put in a safe place).



Fit the actuator using the 2 provided screws to the supplied stainless steel bracket in the orientation shown above.

Using the supplied Torx T30 bit in a impact driver or cordless drill, loosen the left hand bolt approximately 3 turns (do not fully remove), completely remove the remaining 2 Torx bolts. Position the stainless steel bracket under the latch assembly and over the lock.

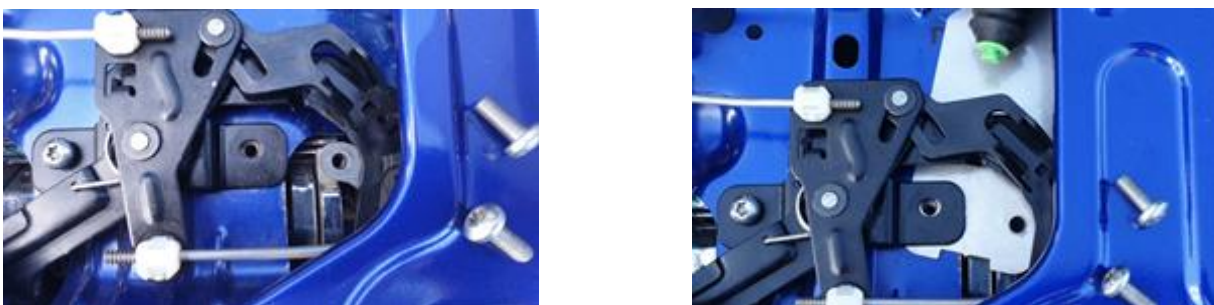

Align the holes within the stainless steel bracket to the latch and lock threads, refit the Torx bolt to the lock mechanism first, do not fully tighten.

Fit the remainder Torx bolt to the latch; once all Torx bolts are in place tighten all 3 securely.



Using the supplied 3mm hex shaft drill bit in a cordless drill or impact driver, drill a 3mm hole in the centre of the plastic latch assembly that you have just marked.

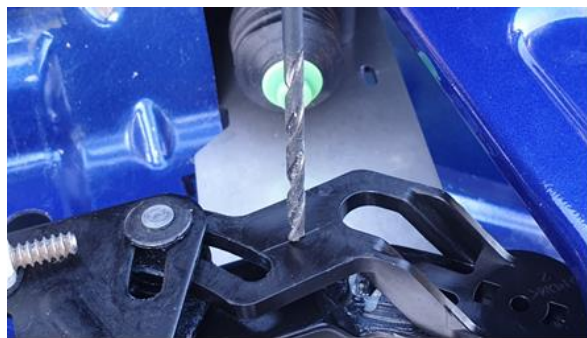

Fit the pre-bent Z bar to the actuator head as shown below first, then fit the Z bar into the 3mm hole clipping back onto the actuator until it locks into position.



Connect the harness to the actuator wires by pushing the corresponding bullet terminals together firmly.

- Black wire to green wire
- Red wire to blue wire



Test operation making sure all doors are closed, when working correctly, use the supplied cable ties to secure all cables, ensure all bolts and screws are securely fastened.

NOTE: Ensure all connectors are fully supported and affixed with cable ties to secure mounting points. Do not let them just hang in place, there is a dedicated fixing point on the actuator stainless steel bracket for the connection point of the harness and actuator bullet terminals.

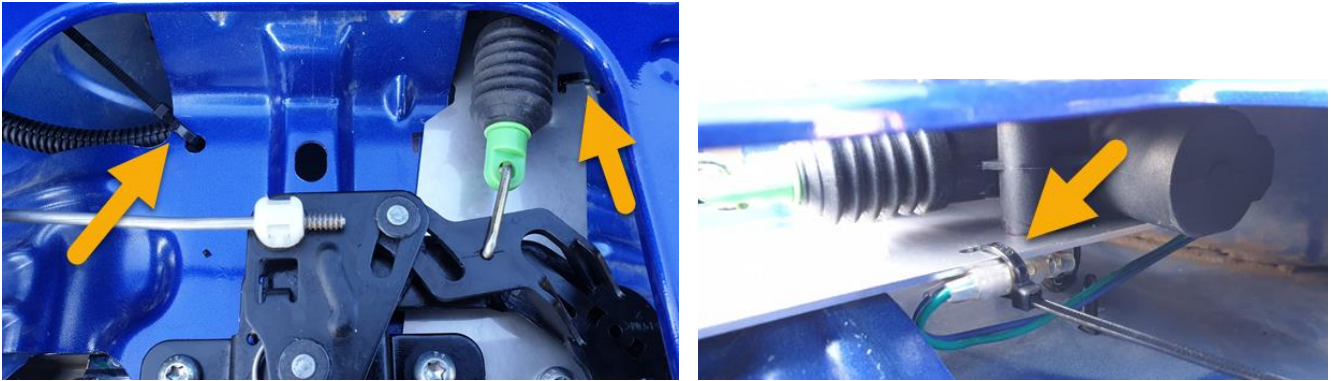

Refit tail gate trim; reinsert all plastic plugs that had been removed from the rear inner guard during the installation process.

Your feedback on these installation instructions are welcome, if you believe there are additional information required, or are incorrect please contact us at info@tracelectronics.com.au

For our expanding range of products refer website:

<https://tracelectronics.com.au/>